

Kew

SURVEYOR'S OFFICE
Hamilton County

Kenton C. Ward, CFM
Surveyor of Hamilton County
Phone (317) 776-8495
Fax (317) 776-9628

Suite 188
One Hamilton County Square
Noblesville, Indiana 46060-2230

February 3, 2015

To: Hamilton County Drainage Board

Re: Cool Creek Drain, Clark & Inman Arm – Lakes of Westfield Reconstruction

Attached is a petition from Langston Development Company, Inc., along with non-enforcement request, plans, calculations, and quantity summary for the proposed reconstruction of the Clark & Inman Arm of the Cool Creek Drain. The proposal is to reconstruct and relocate the drain to allow for residential development.

The reconstructed drain shall consist of reconstruction and relocation of those lengths of pipes between the following structures and Stations as shown on sheet C600A of the plans by Stoeppelwerth & Associates, Inc., dated May 30, 2014, and having job number 45815LAN.

The reconstructed drain shall begin at Sta. 6+00 per the original description, which is where Str. new Str. 239 will be set, then 180 feet of 12" RCP to Str. 240, then 246 feet of 12" RCP to Str. 242, then 110 feet of 12" RCP to Str. 241, which in an end section inlet into a detention pond. The drain then continues as 692 feet of open ditch through Lake #6 to Str. 237, and then 130 feet of 12" RCP to Str. 238, which is a manhole set on the reconstructed drain under Grassy Branch Road at Sta. 18+92 per the original description.

The total length of new drain for this arm shall be 1,358 feet. The 1,292 feet of the original drain between Sta. 6+00 and Sta. 18+92 per the original legal description from 1909 shall be vacated. This proposal will add 66 feet to the Clark & Inman Arm of Cool Creek total length.

The retention pond (Lake #6), which provides regional upstream watershed detention volume, located in future Common Area of Lake of Westfield, Lakes at Grassy Branch is to be considered part of the regulated drain. Pond maintenance shall include the inlet and outlet as part of the regulated drain. Since the pond (Lake #6) provided regional detention storage for upstream watershed area and to provide a benefit to the overall Cool Creek Drain watershed, sediment removal and erosion control along the banks shall also be consider as part of the regulated drain

maintenance. The maintenance of the pond (Lake #6) such as mowing and aquatic vegetation control will be the responsibility of the Homeowners Association. The Board will also retain jurisdiction for ensuring the storage volume for which the pond was designed will be retained, thereby, allowing no fill or easement encroachments.

The cost of the reconstruction is to be paid by Langston Development Company, Inc.

The petitioner has posted the following bond with the City of Westfield to cover all storm sewer work within the development:

Bonding Company: Lexon Insurance Company
Bond Number: 1102405
Bond Date: August 8th, 2014
Bond Amount: \$636,458.00

This reconstruction affects the following parcels and owners:

08-06-32-00-00-001.002	C Stephen Roudebush LLC
08-06-32-00-00-001.101	Langston Residential Development, LLC
Grassy Branch Road ROW	City of Westfield

I recommend that upon approval of the above proposed drain reconstruction that the Board also approves the attached non-enforcement request. The request will be for the reduction of the regulated drain easement to those easement widths for the relocated Clark & Inman as shown on the secondary plat for Lakes of Westfield, Lakes at Grassy Branch Section 1A as recorded in the office of the Hamilton County Recorder.

I recommend the Board set a hearing for this proposed drain for April 27, 2015.

Sincerely,

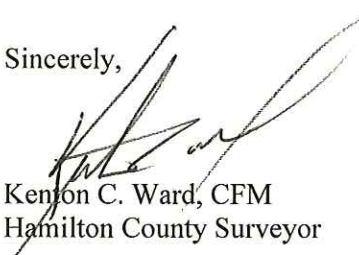

Kenton C. Ward, CFM
Hamilton County Surveyor

KCW/pll

HAMILTON COUNTY DRAINAGE BOARD
NOBLESVILLE, INDIANA

FILED

JUN 23 2014

IN RE: _____)
Hamilton County, Indiana)

OFFICE OF HAMILTON COUNTY SURVEYOR

PETITION FOR RELOCATION AND RECONSTRUCTION

_____ Langston Development _____ (hereinafter "Petitioner"),
hereby petitions the Hamilton County Drainage Board for authority to relocate and improve a
section of the _____ Clark-Inman _____ Drain, and in support of
said petition advises the Board that:

1. Petitioner owns real estate through which a portion of the _____ Clark-Inman _____
Drain runs.
2. Petitioner plans to develop its real estate with roads, buildings, utilities, storm drains,
sanitary sewers and other structures.
3. Petitioner's proposed development of its real estate will require relocation and
reconstruction of a portion of the _____ Clark-Inman _____ Drain, as
specifically shown on engineering plans and specifications filed with the Hamilton
County Surveyor.
4. The work necessary for the proposed relocation and reconstruction will be undertaken at
the sole expense of the Petitioner and such work will result in substantial improvement to
the _____ Clark-Inman _____ Drain, without cost to other property owners
on the watershed of the _____ Clark-Inman _____ Drain.

WHEREFORE, Petitioner requests that an Order issued from the Hamilton County
Drainage Board authorizing relocation and reconstruction of the _____ Clark-Inman _____
Drain, in conformance with applicable law and plans and specifications on file with the Hamilton
County Surveyor.

Signed

Printed



John Edwards

FINDINGS AND ORDER
CONCERNING THE PARTIAL VACATION OF THE
Cool Creek Drain, Clark & Inman Arm
Lakes of Westfield Reconstruction
Station 6+00 to Station 18+92

On this 27th day of April, 2015, the Hamilton County Drainage Board has held a hearing on the Maintenance Report and Schedule of Assessments of the *Cool Creek Drain, Clark & Inman Arm, Lakes of Westfield Reconstruction - Station 6+00 to Station 18+92.*

Evidence has been heard. Objections were presented and considered. The Board then adopted an order of action. The Board now finds that the costs of continued maintenance to the portion of the above drain exceed the benefits to the real estate benefited by the portion of the drain to be abandoned and issues this order vacating the above section of the *Cool Creek Drain, Clark & Inman Arm, Lakes of Westfield Reconstruction - Station 6+00 to Station 18+92.*

HAMILTON COUNTY DRAINAGE BOARD

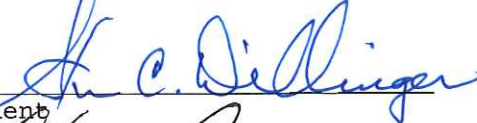

President



Member



Member

Attest: 

STATE OF INDIANA)
) ss:
COUNTY OF HAMILTON)

BEFORE THE HAMILTON COUNTY
DRAINAGE BOARD
NOBLESVILLE, INDIANA

IN THE MATTER OF THE
RECONSTRUCTION OF THE
Cool Creek Drain, Clark & Inman Arm, Lakes of Westfield Reconstruction

FINDINGS AND ORDER FOR RECONSTRUCTION

The matter of the proposed Reconstruction of the *Cool Creek Drain, Clark & Inman Arm, Lakes of Westfield Reconstruction* came before the Hamilton County Drainage Board for hearing on *April 27, 2015*, on the Reconstruction Report consisting of the report and the Schedule of Damages and Assessments. The Board also received and considered the written objection of an owner of certain lands affected by the proposed Reconstruction, said owner being:

Evidence was heard on the Reconstruction Report and on the aforementioned objections.

The Board, having considered the evidence and objections, and, upon motion duly made, seconded and unanimously carried, did find and determine that the costs, damages and expenses of the proposed Reconstruction will be less than the benefits accruing to the owners of all land benefited by the Reconstruction.

The Board having considered the evidence and objections, upon motion duly made, seconded and unanimously carried, did adopt the Schedule of Assessments as proposed, subject to amendment after inspection of the subject drain as it relates to the lands of any owners which may have been erroneously included or omitted from the Schedule of Assessments.

The Board further finds that it has jurisdiction of these proceedings and that all required notices have been duly given or published as required by law.

Wherefore, it is ORDERED, that the proposed Reconstruction of the *Cool Creek Drain, Clark & Inman Arm, Lakes of Westfield Reconstruction* be and is hereby declared established.

Thereafter, the Board made inspection for the purpose of determining whether or not the lands of any owners had been erroneously included or excluded from the Schedule of Assessments. The Board finds on the basis of the reports and findings at this hearing as follows:

HAMILTON COUNTY DRAINAGE BOARD

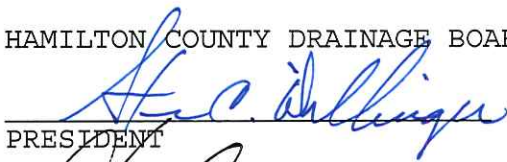

PRESIDENT

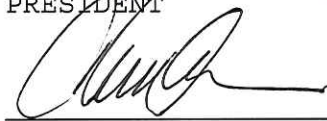

Member



Member

ATTEST:

Executive Secretary



August 6, 2014

Hamilton County Surveyor's Office
One Hamilton County Square, Suite 188
Noblesville, Indiana 46060

Attention Greg Hoyes

Re: The Lakes of Westfield, Section 1A

Dear Mr. Hoyes:

On behalf of the developer Langston Development Co., Inc. please accept this Engineer's Estimate for The Lakes of Westfield, Section 1A. The estimate is as follows:

Item	Unit	Unit Cost	Quantities	Cost	120%	Performance Bond Amount
Storm Sewers						
12 in. RCP	LF	\$16.00	1060	\$16,960.00	120%	\$20,352.00
15 in. RCP	LF	\$18.60	905	\$16,833.00	120%	\$20,199.60
18 in. RCP	LF	\$19.75	592	\$11,692.00	120%	\$14,030.40
21 in. RCP	LF	\$22.30	446	\$9,945.80	120%	\$11,934.96
24 in. RCP	LF	\$28.00	313	\$8,764.00	120%	\$10,516.80
27 in. RCP	LF	\$32.15	201	\$6,462.15	120%	\$7,754.58
Storm Manholes	EA	\$2,900.00	1	\$2,900.00	120%	\$3,480.00
Yard Inlets	EA	\$1,750.00	14	\$24,500.00	120%	\$29,400.00
Curb Inlets	EA	\$1,500.00	13	\$19,500.00	120%	\$23,400.00
Curb Underdrain	LF	\$6.70	5,260	\$35,242.00	120%	\$42,290.40
Swale Underdrain	LF	\$6.70	2,657	\$17,801.90	120%	\$21,362.28
SSD Risers	EA	\$105.00	9	\$945.00	120%	\$1,134.00
Lot Leads	EA	\$85.00	37	\$3,145.00	120%	\$3,774.00
Granular Fill	TONS	\$9.00	1,100	\$9,900.00	120%	\$11,880.00
Total Storm Sewers & SSD				\$184,590.85	120%	\$221,509.02

If you have any questions, please give Brian K. Robinson a call at (317) 570-4763. Witness my signature this August 6, 2014.

David J. Stoepfelwerth, P.E.
Professional Engineer
No. 19358



Cc: Jim Langston
/meb

S:\45815LAN\Blue_Book\Agency_Correspondence\HamiltonCountySurveyorHoyesEE5ec1A-08-06-14.docx-



August 6, 2014

City of Westfield
Department of Public Works
2706 East 171st Street
Westfield, Indiana 46074

Attention: Dustin Shoe

Re: The Lakes of Westfield, Section 1A

Dear Mr. Shoe:

On behalf of the developer Langston Development Co., Inc. enclosed please find an Engineer' Estimate for The Lakes of Westfield, Section 1A. The estimate is as follows:

Item	Unit	Unit Cost	Quantities	Cost	110%	Performance Bond Amount
Curbs						
Roll Curb	LF	\$6.15	5,260	\$32,349.00	110%	\$35,583.90
Chairback Curb	LF	\$10.00	600	\$6,000.00	110%	\$6,600.00
			Total Curbs	\$38,349.00	110%	\$42,183.90
Streets						
Local Street Section	SY	\$19.86	8,158	\$162,017.88	110%	\$178,219.67
Grassy Branch R/W Section	SY	\$38.90	1,478	\$57,494.20	110%	\$63,243.62
Mill & Re-Surface	SY	\$11.38	1,669	\$18,993.22	110%	\$20,892.54
			Total Asphalt & Stone	\$238,505.30	110%	\$262,355.83
			Total Streets & Curbs	\$276,854.30	110%	\$304,539.73
Common Area Sidewalks & Pathways						
8 ft. Pathway Standard Concrete	SY	\$19.90	1,478	\$29,412.20	110%	\$32,353.42
Sidewalk	SF	\$3.29	2,975	\$9,787.75	110%	\$10,766.53
			Total Sidewalks & Paths	\$39,199.95	110%	\$43,119.95
Erosion Control						
Initial Silt Fence	LF	\$1.10	2,500	\$2,750.00	110%	\$3,025.00
Concrete Wash Area	EA	\$287.00	2	\$574.00	110%	\$631.40
Check Dams	EA	\$135.00	6	\$810.00	110%	\$891.00
Secondary Silt Fence Installation	LF	\$1.10	6,500	\$7,150.00	110%	\$7,865.00
R/W Seed/Straw & Tac	SF	\$0.05	147,323	\$7,366.15	110%	\$8,102.77
Lot Overseeding	SF	\$0.02	882,396	\$17,647.92	110%	\$19,412.71

Swales	SF	\$0.06	180,589	\$10,835.34	110%	\$11,918.87
Pond Blankets	SF	\$0.16	171,526	\$27,444.16	110%	\$30,188.58
Inlet Protection	EA	\$125.00	27	\$3,375.00	110%	\$3,712.50
Total Erosion Control				\$77,952.57	110%	\$85,747.83
Monuments & Markers						
Centerline Monuments	EA	\$170.00	10	\$1,700.00	110%	\$1,870.00
Concrete Monuments	EA	\$225.00	2	\$450.00	110%	\$495.00
Lot Corners	EA	\$100.00	37	\$3,700.00	110%	\$4,070.00
Total Monuments & Markers				\$5,850.00	110%	\$6,435.00
Grand Total				\$399,856.82	110%	\$439,842.50

If you have any questions regarding these estimates, please contact Brian K. Robinson at brobinson@stoepfelwerth.com or on his direct line at (317) 570-4763.

Very truly yours,

STOEPPELWERTH & ASSOCIATES, INC.

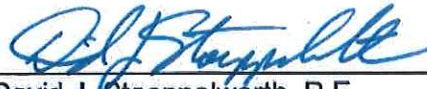

David J. Stoepfelwerth, P.E.
 Professional Engineer
 No. 19358

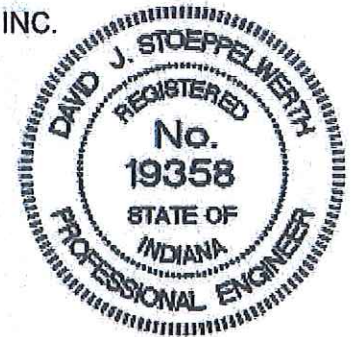

Cc: Jim Langston

/meb

S:\45815LAN\Blue_Book\Agency_Correspondence\WestfieldPublicWorksShoeEE08-06-14.docx



SUBDIVISION BOND

Bond No.: 1102405

Principal Amount: \$636,458.00

KNOW ALL MEN BY THESE PRESENTS, that we **Langston Development Company, Inc., 1132 S. Rangeline Road, Suite 100 Carmel, IN 46032** as Principal, and **Lexon Insurance Company, 12890 Lebanon Road, Mt. Juliet, TN 37122**, an Texas Corporation, as Surety, are held and firmly bound unto **Westfield Public Works, 2706 E. 171st Street, Westfield, IN 46074**, as Obligee, in the penal sum of **Six Hundred Thirty Six Thousand Four Hundred Fifty Eight and No/100 (Dollars) (\$636,458.00)**, lawful money of the United States of America, for the payment of which well and truly to be made, we bind ourselves, our heirs, executors, administrators, successors and assigns, jointly and severally, firmly by these presents.

WHEREAS, **Langston Development Company, Inc.** has agreed to construct in **Lakes of Westfield, Section 1A Subdivision**, in Westfield, IN the following improvements:

Streets, Curbs, Storm Sewers, Sidewalks, Trails and Erosion Control

NOW, THEREFORE, THE CONDITION OF THIS OBLIGATION IS SUCH, that if the said Principal shall construct, or have constructed, the improvements herein described, and shall save the Obligee harmless from any loss, cost or damage by reason of its failure to complete said work, then this obligation shall be null and void, otherwise to remain in full force and effect, and the Surety, upon receipt of a resolution of the Obligee indicating that the improvements have not been installed or completed, will complete the improvements or pay to the Obligee such amount up to the Principal amount of this bond which will allow the Obligee to complete the improvements.

Upon approval by the Obligee, this instrument may be proportionately reduced as the public improvements are completed.

Signed, sealed and dated, this 8th day of August, 2014

Langston Development Company, Inc.
Principal

Lexon Insurance Company
Surety

By: _____



By: _____

Dawn L Morgan
Dawn L Morgan, Attorney-in-Fact

BEFORE THE HAMILTON COUNTY DRAINAGE BOARD
IN THE MATTER OF

*Cool Creek Drain, Clark & Inman Arm
Lakes of Westfield Reconstruction*

NOTICE

To Whom It May Concern and: _____

Notice is hereby given of the hearing of the Hamilton County Drainage Board concerning the reconstruction of the **Cool Creek Drain, Clark & Inman Arm, Lakes of Westfield Reconstruction** on **April 27, 2015 at 9:05 A.M.** in Commissioners Court, Hamilton County Judicial Center, One Hamilton County Square, Noblesville, Indiana. Construction and maintenance reports of the Surveyor and the Schedule of Assessments proposed by the Drainage Board have been filed and are available for public inspection in the office of the Hamilton County Surveyor.

Hamilton County Drainage Board

Attest: Lynette Mosbaugh

ONE TIME ONLY

STATE OF INDIANA)
) SS BEFORE THE HAMILTON
)
COUNTY OF HAMILTON) DRAINAGE BOARD

**IN THE MATTER OF Cool Creek Drain, Clark & Inman Arm, Lakes
of Westfield Reconstruction**

NOTICE

Notice is hereby given that the Hamilton County Drainage Board at its regular meeting **April 27, 2015** adopted the reconstruction report of the Surveyor and the Amended Schedule of damages and assessments including annual assessment for periodic maintenance, finding that the costs, damages and expense of the proposed improvement would be less than the benefits which will result to the owner of lands benefited thereby.

The Board issued an order declaring the proposed improvement established. Such findings and order were marked filed and are available for inspection in the Office of the Hamilton County Surveyor.

If judicial review of the findings and order of the Board is not requested pursuant to Article VIII of the 1965 Indiana Drainage Code as amended within twenty (20) days from the date of publication of this notice, the findings and order shall become conclusive.

HAMILTON COUNTY DRAINAGE BOARD

BY: Steven C. Dillinger
PRESIDENT

ATTEST: Lynette Mosbaugh
SECRETARY

26

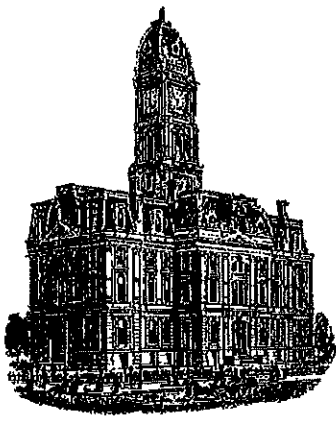

SURVEYOR'S OFFICE
Hamilton County

Kenton C. Ward, CFM
Surveyor of Hamilton County
Phone (317) 776-8495
Fax (317) 776-9628

Suite 188
One Hamilton County Square
Noblesville, Indiana 46060-2230

To: Hamilton County Drainage Board

September 8, 2017

Re: Cool Creek Drain: Clark & Inman – Lakes of Westfield Reconstruction

Attached are as-built, certificate of completion & compliance, and other information for Lakes of Westfield Reconstruction. An inspection of the drainage facilities for this section has been made and the facilities were found to be complete and acceptable.

During construction, changes were made to the drain, which will alter the plans submitted with my report for this drain-dated. The report was approved by the Board at the hearing held April 27, 2015. (See Drainage Board Minutes Book 16, Pages 172-174) The changes are as follows: there is now 61' of 15" RCP, 547 feet of 12" RCP, and 665 feet of open ditch. The length of the drain due to the changes described above is now **1,273 feet**. The project removed 1292 feet of 10" tile between Sta. 6+00 to 18+92 of original Clark –Inman Drain. Therefore, 19 feet of drain was removed from the drain's overall length.

The non-enforcements were approved by the Board at meetings on April 27, 2015 and November 9, 2015. The documents were recorded under instrument numbers #2015019635 and #2016054067.

The project was paid for by the developer and the sureties were held by the City of Westfield to cover all storm drain facilities within the development.

I recommend the Board approve the drain's construction as complete and acceptable.

Sincerely,

Kenton C. Ward, CFM
Hamilton County Surveyor

CERTIFICATE OF COMPLETION AND COMPLIANCE

To: Hamilton County Surveyor

Re: Lakes of Westfield, Sections 1A & 1B

I hereby certify that:

1. I am a Registered Land Surveyor or Engineer in the State of Indiana.
2. I am familiar with the plans and specifications for the above referenced subdivision.
3. I have personally observed and supervised the completion of the drainage facilities for the above referenced subdivision.
4. The drainage facilities within the above referenced subdivision to the best of my knowledge, information and belief have been installed and completed in conformity with all plans and specifications.
5. The drainage facilities within the above referenced subdivision to the best of my knowledge, information and belief have been correctly represented on the Record Drawings, Digital Record Drawings and the Structure Data Spreadsheet.

Signature:  Date: September 15, 2015

Type or Print Name: David J. Stoepfelwerth

Business Address: Stoepfelwerth & Associates, Inc.

7965 East 106th Street, Fishers, Indiana 46038

Telephone Number: (317) 849-5935

SEAL



INDIANA REGISTRATION NUMBER

19358

Project No. 24-04-01-01-00-000-003
 Drawn: Dennis D. Olmstead, Registered Land Surveyor
 Property Use: City of Family Housing Project

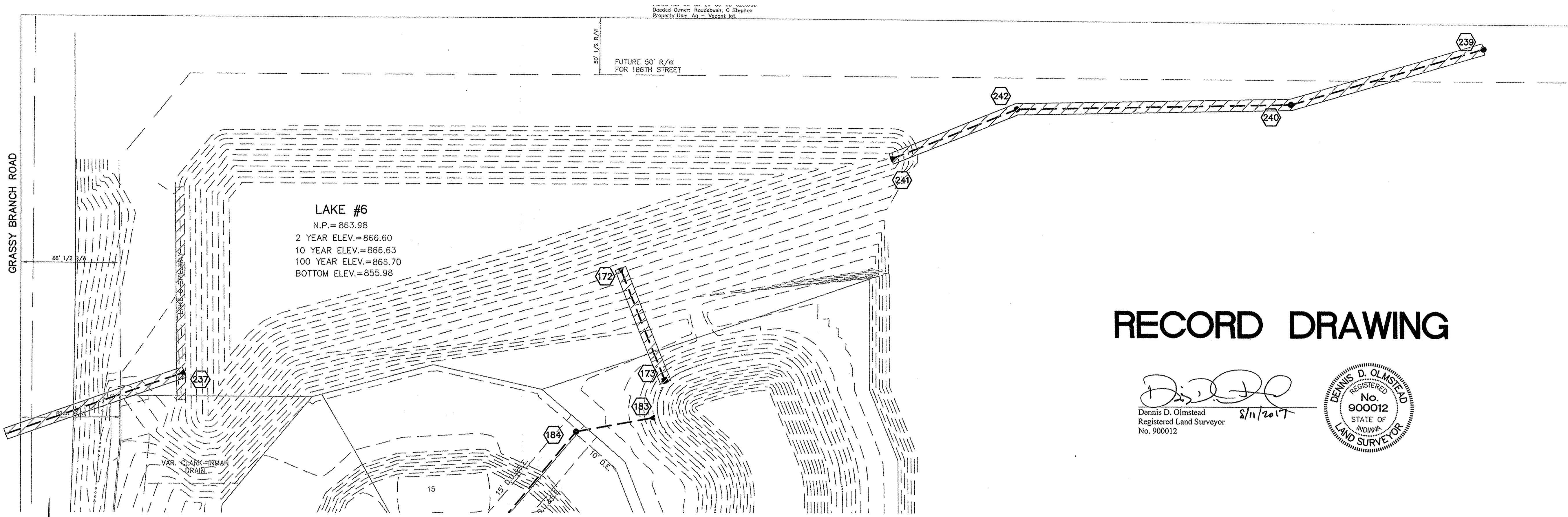

RECORD DRAWING

Dennis D. Olmstead
 Dennis D. Olmstead
 Registered Land Surveyor
 No. 900012
 8/11/2017



CERTIFIED: 05/30/14
David J. Stoppelwerth

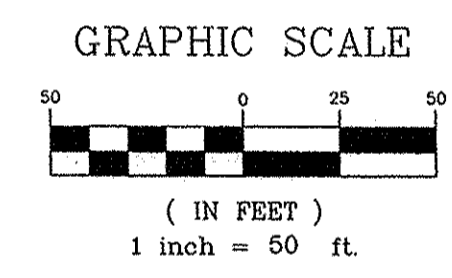
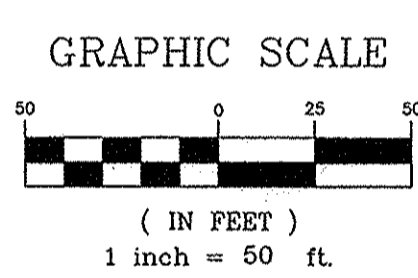

- LEGEND**
- EXISTING SANITARY SEWER
 - EXISTING STORM SEWER
 - PROPOSED SANITARY SEWER
 - PROPOSED STORM SEWER
 - PROPOSED WATER LINE

DENOTES FULL DEPTH GRANULAR BACKFILL

NOTES:

ALL STORM STRUCTURES TO RECEIVE SOLID LID CASTINGS ARE TO BE CONSTRUCTED TO PROVIDE ONE 4" RISER RING NO MORE, NO LESS TO ACHIEVE PLAN RIM GRADE.

ALL YARD INLETS ARE TO BE CONSTRUCTED AT A TOLERANCE OF +0.00' TO -0.20' OF PLAN GRADE.

ALL STORM SEWER CASTINGS SHALL BE LABELED "DUMP NO WASTE-DRAINS TO WATERWAY"

ALL STORM CROSSINGS IN RIGHT OF WAY WITH LESS THAN 30" COVER TO FINISH PAVEMENT GRADE WILL BE BACKFILLED WITH #8 STONE

ALL SSD'S (SUBSURFACE DRAINS) WILL NEED TO BE DOUBLE WALL SMOOTH BORE PERFORATED (HDPE) PIPE

DEBRIS GUARDS ARE TO BE INSTALLED ON ALL OPEN ENDED INLETS.

ALL STORM TO BE CLEANED AND TELEVISED AFTER ALL UNDERGROUND UTILITIES ARE INSTALLED.

STORM STRUCTURES DEEPER THAN 4' MUST BE ACCESSIBLE WITH STEPS.

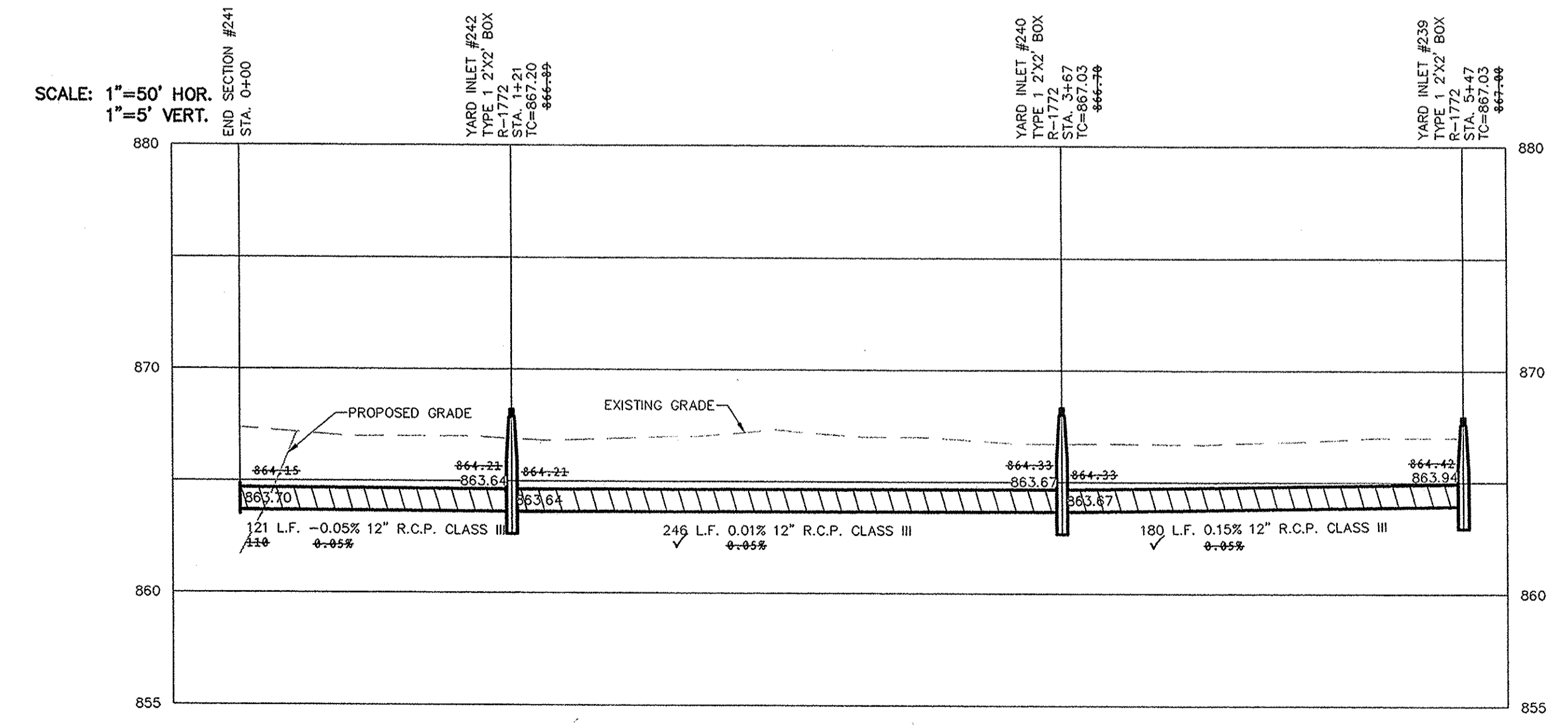
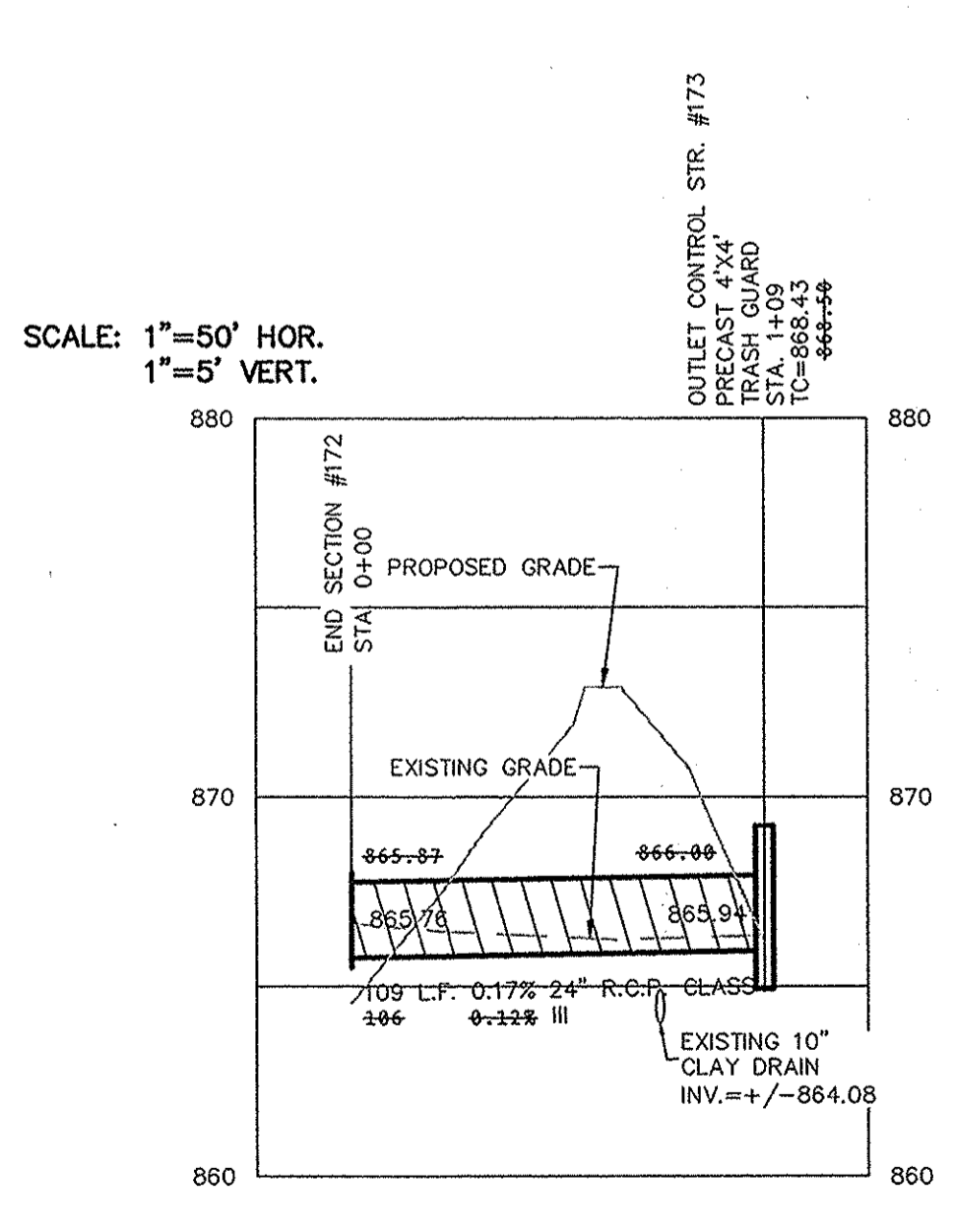
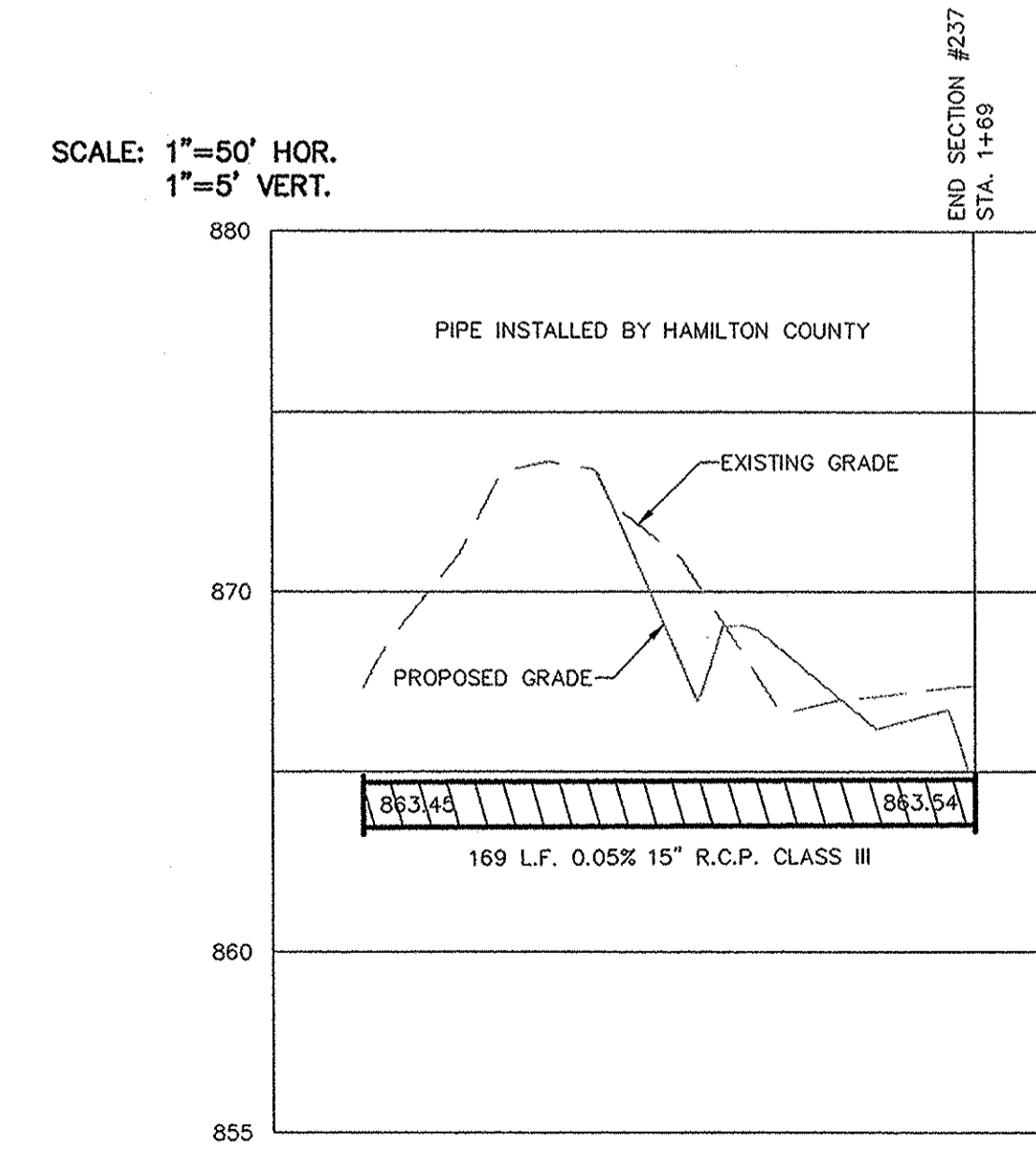

This information was gathered for input into the Hamilton County Geographic Information System (GIS). This document is considered an official record of the GIS.

Entry Date: Sept 2017

Entered By: GLM

File Name: S:\45815LAN\C600A Storm Plans & Profiles.dwg - C600A
 Modified By: M. J. ...
 Plotted By: August 10, 2017 2:58:27 PM / Christian Esposito

STOEPPELWERTH
 ALWAYS ON
 7905 East 100th Street, Fishers, IN 46038-2505
 phone: 317.849.5935 fax: 317.849.5942

WESTFIELD
 HAMILTON COUNTY, INDIANA

STORM PLAN & PROFILE
LAKES OF WESTFIELD
SECTION 1A & 1B

DRAWN BY: JSM
 CHECKED BY: BKR
 SHEET NO. C600A
 S & A JOB NO. 45815LAN